

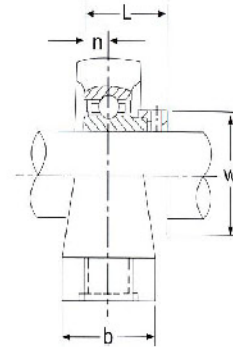

## Silver Series Zamak Housing

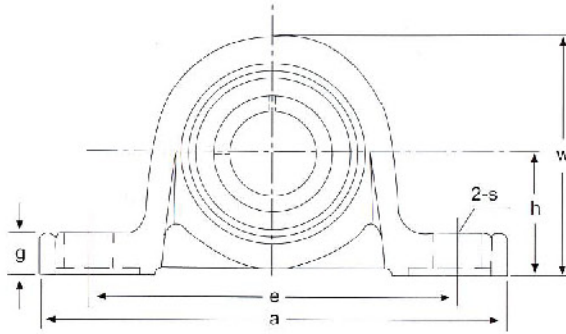

Dimension table . Dimensions in mm

Unit No.	Shaft (mm)											Bolt Size	Bearing No.	Housing No.	Weight
	d	h	a	e	b	s	g	W	L	n	w	mm			kg
UP 000	10	18	67	53	16	7	6	35	17.5	4	17	M6	U 000	P 000	0.08
UP 001	12	19	71	56	16	7	6	38	17.5	4	19	M6	U 001	P 001	0.10
UP 002	15	22	80	63	16	7	7	43	18.5	4.5	22	M6	U 002	P 002	0.14
UP 003	17	24	85	67	18	7	7	47	20.5	5	25	M6	U 003	P 003	0.17
UP 004	20	28	100	80	20	10	9	55	24.5	6	30	M8	U 004	P 004	0.26
UP 005	25	32	112	90	20	10	10	62	25.5	6	36	M8	U 005	P 005	0.33
UP 006	30	36	132	106	26	13	11	70	26.5	6.5	42	M10	U 006	P 006	0.50



**Silver series zamak housing**

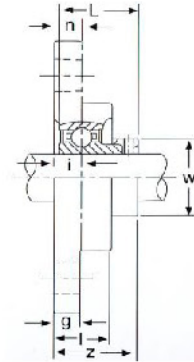
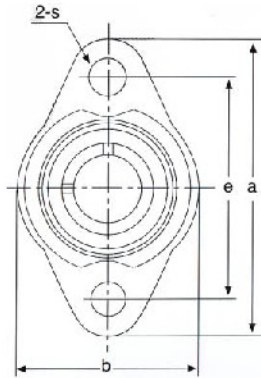

**Dimension table . Dimensions in mm**

Unit No.	Shaft (mm)												Bolt Size mm	Bearing No.	Housing No.	Weight kg
	d	a	e	i	g	l	s	b	Z	L	n	w				
UFL 000	10	60	45	5.5	5.5	11.5	7	36	19	17.5	4	17	M6	U 000	FL 000	0.07
UFL 001	12	63	48	5.5	5.5	11.5	7	38	19	17.5	4	19	M6	U 001	FL 001	0.08
UFL 002	15	67	53	6.5	6.5	13	7	42	20.5	18.5	4.5	22	M6	U 002	FL 002	0.11
UFL 003	17	71	56	7	7	14	7	46	22.5	20.5	5	25	M6	U 003	FL 003	0.14
UFL 004	20	90	71	8	8	16	10	55	26.5	24.5	6	30	M8	U 004	FL 004	0.23
UFL 005	25	95	75	8	8	16	10	60	27.5	25.5	6	36	M8	U 005	FL 005	0.27
UFL 006	30	112	85	9	9	18	13	70	29	26.5	6.5	42	M10	U 006	FL 006	0.39
UFL 007	35	122	95	10	10	20	13	80	32.5	29.5	7	48	M10	U 007	FL 007	0.50



**Silver series zamak housing**

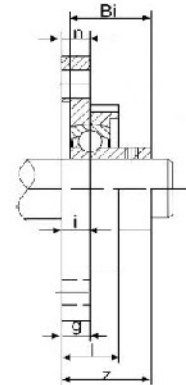
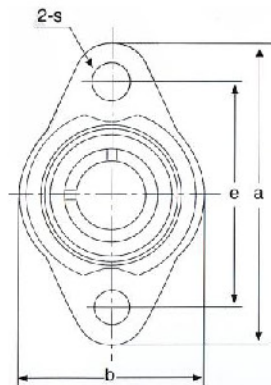

**Dimension table . Dimensions in mm**

Unit No.	Shaft (mm)											Bolt Size	Bearing No.	Housing No.	Weight
	d	a	e	i	g	l	s	b	Z	n	Bi	mm			kg
KFL 000	10	60	45	6	6	12	7	36	16	4	14	M6	K 000	FL 000	0.07
KFL 001	12	63	48	6	6	12	7	38	16.5	4	14.5	M6	K 001	FL 001	0.08
KFL 002	15	67	53	6.5	6.5	13	7	42	18.5	4.5	16.5	M6	K 002	FL 002	0.11
KFL 003	17	71	56	7	7	14	7	46	19.5	5	17.5	M6	K 003	FL 003	0.14
KFL 004	20	90	71	8	8	16	10	55	23	6	21	M8	K 004	FL 004	0.23
KFL 005	25	95	75	8	8	16	10	60	24.5	6	22.5	M8	K 005	FL 005	0.27
KFL 006	30	112	85	9	9	18	13	70	27	6.5	24.5	M10	K 006	FL 006	0.39