

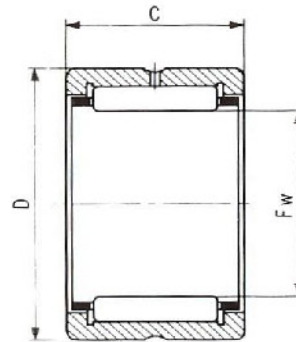

## Needle Roller Bearing

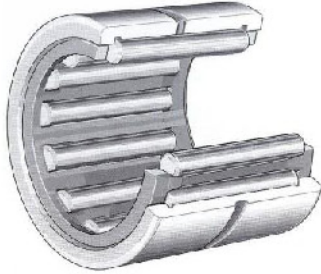

**Dimension table . Dimensions in inch**

Number	Number	Mass (g)	Dimensions (mm/inch)			Basic dynamic load rating C N	Basic Static load rating C <sub>0</sub> N	Allwable rotational speed (²) rpm
			F <sub>w</sub>	D	C			
MR 10 N	BR 101812	49	15.875 ( <sup>5</sup> / <sub>8</sub> )	28.575 (1.1 <sup>1</sup> / <sub>8</sub> )	19.050 ( <sup>3</sup> / <sub>4</sub> )	17 955	18 715	23 750
MR 12 N	BR 122012	56	19.050 ( <sup>3</sup> / <sub>4</sub> )	31.750 (1.1 <sup>1</sup> / <sub>4</sub> )	19.050 ( <sup>3</sup> / <sub>4</sub> )	20 615	23 180	19 000
MR 12	BR 122016	75	19.050 ( <sup>3</sup> / <sub>4</sub> )	31.750 (1.1 <sup>1</sup> / <sub>4</sub> )	25.400 (1)	26 220	31 445	19 000
MR 14 N	BR 142212	63	22.225 ( <sup>7</sup> / <sub>8</sub> )	34.925 (1.3 <sup>3</sup> / <sub>8</sub> )	19.050 ( <sup>3</sup> / <sub>4</sub> )	21 850	25 745	17 100
MR 14	BR 142216	84.5	22.225 ( <sup>7</sup> / <sub>8</sub> )	34.925 (1.3 <sup>3</sup> / <sub>8</sub> )	25.400 (1)	27 645	34 960	17 100
MR 16 N	BR 162412	69	25.400 (1")	38.100 (1.1 <sup>1</sup> / <sub>2</sub> )	19.050 ( <sup>3</sup> / <sub>4</sub> )	24 035	30 305	15 200
MR 16	BR 162416	92.5	25.400 (1")	38.100 (1.1 <sup>1</sup> / <sub>2</sub> )	25.400 (1)	30 495	41 135	15 200
MR 18 N	BR 182616	102	28.575 (1.1 <sup>1</sup> / <sub>8</sub> )	41.275 (1.5 <sup>5</sup> / <sub>8</sub> )	25.400 (1)	33 155	47 405	13 300
MR 18	BR 182620	128	28.575 (1.1 <sup>1</sup> / <sub>8</sub> )	41.275 (1.5 <sup>5</sup> / <sub>8</sub> )	31.750 (1.1 <sup>1</sup> / <sub>4</sub> )	41 040	62 320	13 300
MR 20 N	BR 202816	110	31.750 (1.1 <sup>1</sup> / <sub>4</sub> )	44.450 (1.3 <sup>3</sup> / <sub>4</sub> )	25.400 (1)	34 200	50 825	12 350
MR 20	BR 202820	138	31.750 (1.1 <sup>1</sup> / <sub>4</sub> )	44.450 (1.3 <sup>3</sup> / <sub>4</sub> )	31.750 (1.1 <sup>1</sup> / <sub>4</sub> )	42 370	66 785	12 350
MR 22 N	BR 223016	119	34.925 (1.3 <sup>3</sup> / <sub>8</sub> )	47.625 (1.7 <sup>7</sup> / <sub>8</sub> )	25.400 (1)	36 575	57 000	10 450
MR 22	BR 223020	149	34.925 (1.3 <sup>3</sup> / <sub>8</sub> )	47.625 (1.7 <sup>7</sup> / <sub>8</sub> )	31.750 (1.1 <sup>1</sup> / <sub>4</sub> )	45 315	74 955	10 450
MR 24 N	BR 243316	149	38.100 (1.1 <sup>1</sup> / <sub>2</sub> )	52.388 (2.1 <sup>1</sup> / <sub>16</sub> )	25.400 (1)	41 515	63 555	10 450
MR 24	BR 243320	187	38.100 (1.1 <sup>1</sup> / <sub>2</sub> )	52.388 (2.1 <sup>1</sup> / <sub>16</sub> )	31.750 (1.1 <sup>1</sup> / <sub>4</sub> )	51 490	83 790	10 450
MR 26 N	BR 263516	158	41.275 (1.5 <sup>5</sup> / <sub>8</sub> )	55.562 (2.3 <sup>3</sup> / <sub>16</sub> )	25.400 (1)	42 560	67 355	9 025
MR 26	BR 263520	199	41.275 (1.5 <sup>5</sup> / <sub>8</sub> )	55.562 (2.3 <sup>3</sup> / <sub>16</sub> )	31.750 (1.1 <sup>1</sup> / <sub>4</sub> )	52 820	88 730	9 025
MR 28 N	BR 283716	170	44.450 (1.3 <sup>3</sup> / <sub>4</sub> )	58.738 (2.5 <sup>5</sup> / <sub>16</sub> )	25.400 (1)	45 125	74 290	8 550
MR 28	BR 283720	215	44.450 (1.3 <sup>3</sup> / <sub>4</sub> )	58.738 (2.5 <sup>5</sup> / <sub>16</sub> )	31.750 (1.1 <sup>1</sup> / <sub>4</sub> )	55 955	97 850	8 550